









2 P-RAILS | 1 VOLUME push/pull coil split

1 TONE push/pull coil split

3 WAY TOGGLE

Volume push/pull	Tone push/pull	
 Up	 Up	Parallel (both coils on)
 Down	 Up	P-90 coils are selected (Rails are shut off)
 Up	 Down	Rail coils are selected (P-90's are shut off)
 Down	 Down	Series (both coils on)

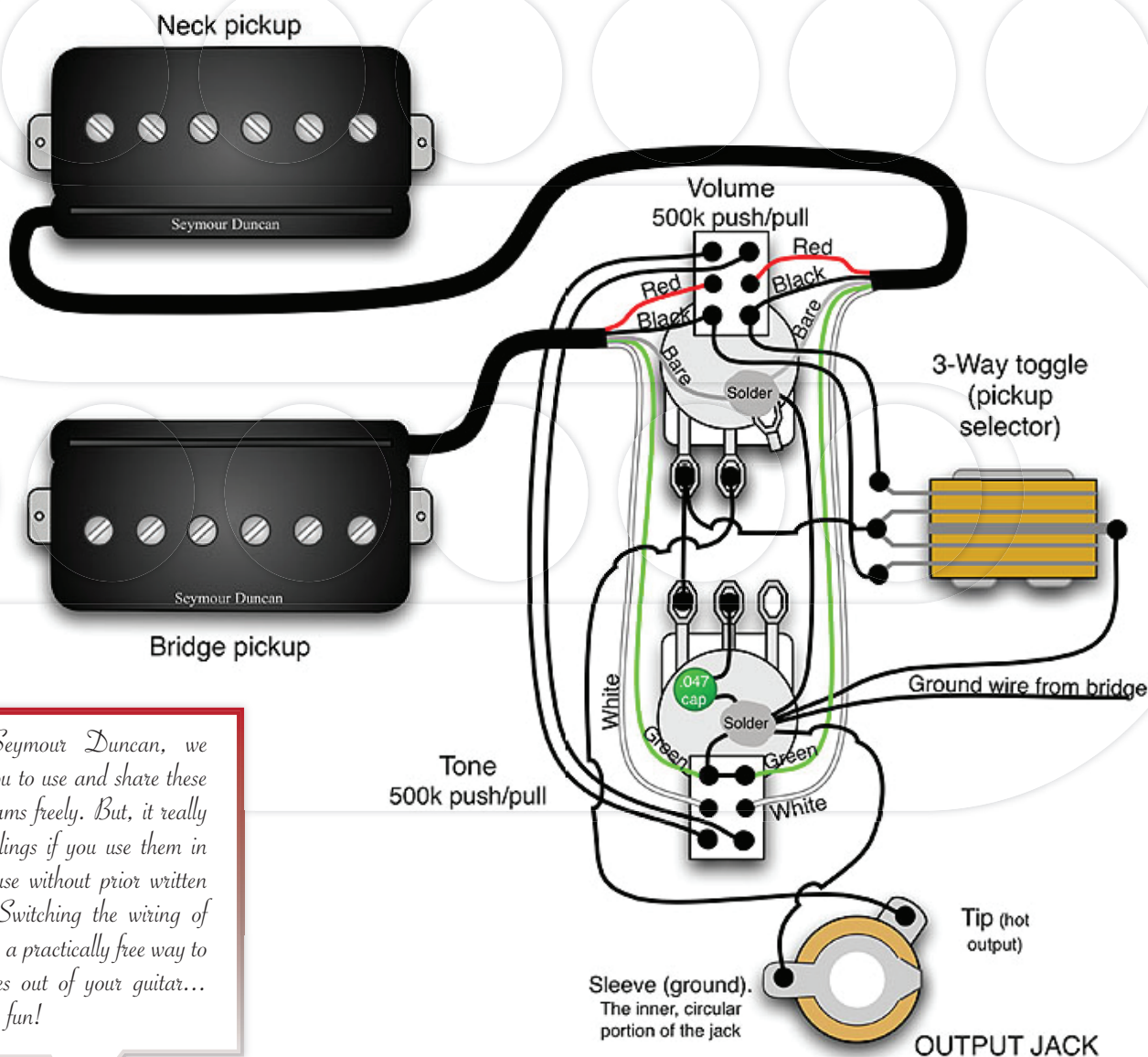

Here at Seymour Duncan, we encourage you to use and share these wiring diagrams freely. But, it really hurts our feelings if you use them in commercial use without prior written permission. Switching the wiring of your guitar is a practically free way to get new tones out of your guitar... Now go have fun!